

HICKORY RIDGE ASSEMBLAGE
(CITY OF WOODSTOCK)

LANDMARK
FOR INFORMATION CONTACT:
SAM INVESTMENT HOLDINGS, LLC
ASHLEY HOLCOMB
1100 HOWELL BRIDGE RD.
BALL GROUND, GA. 30107
770-735-1100

ZONING PLAN
-FOR-
HICKORY RIDGE ASSEMBLAGE
LAND LOTS: - 1169 & 1170
DISTRICT: - 15 - SECTION - 2
CITY: WOODSTOCK - OSWALD COUNTY, GEORGIA
LAST REVISED ON: 2, 2018 SCALE: 1" = 30 FT.
DWG FILE: SHALL ZONING PLAN.dwg CA 157 0000050
JOB NO. 18-435

CURRENT TRACT
CURRENT ZONING: G.C.
CURRENT ZONING: R3C
PROPOSED
AREA = 0.48 ACRES

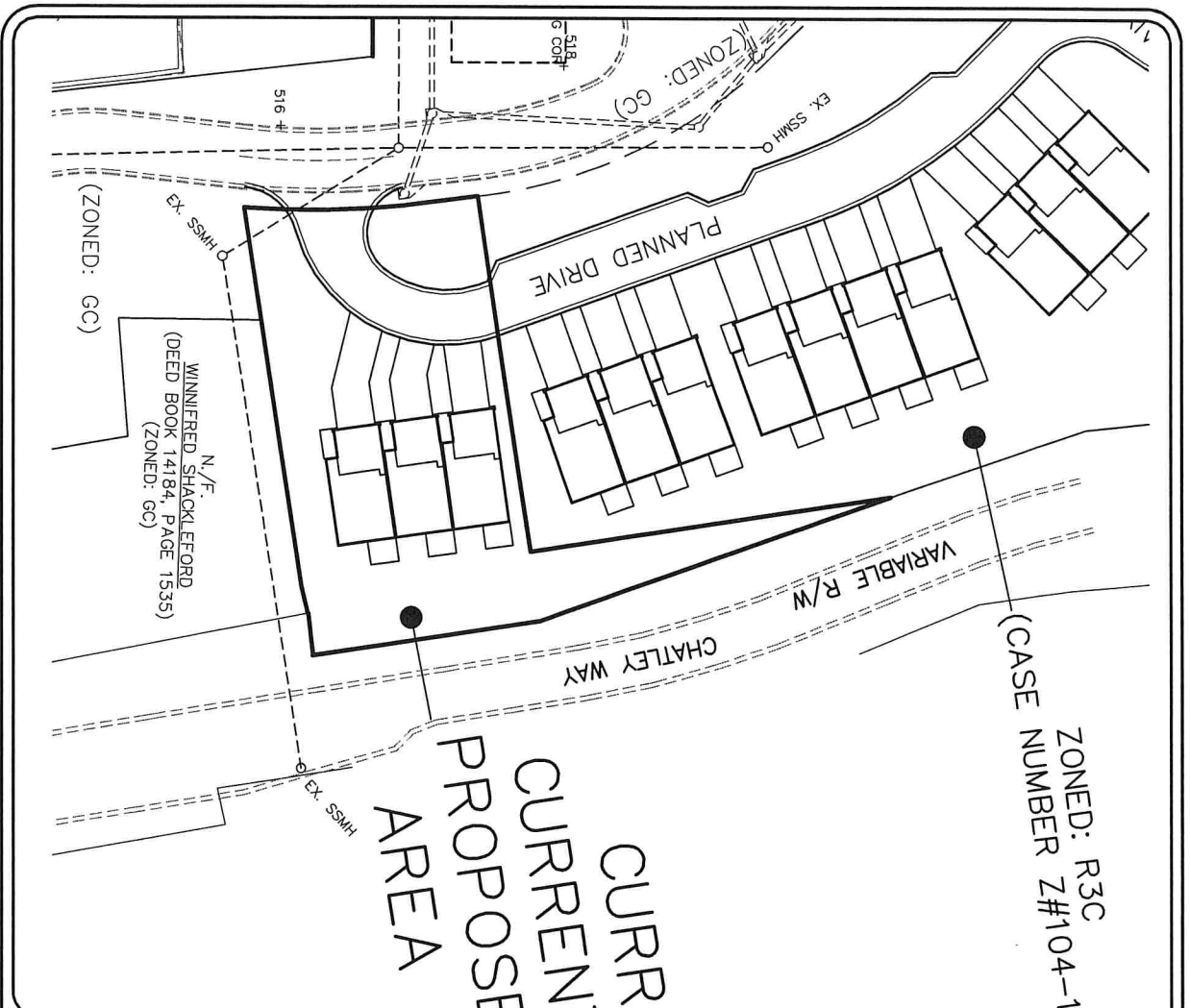

ZONED: R3C
 (CASE NUMBER Z#104-17)

CURRENT TRACT
 CURRENT ZONING: G.C.
 CURRENT ZONING: R3C
 PROPOSED ZONING: R3C
 AREA = 0.48 ACRES

FOR INFORMATION CONTACT:
 ASHLEY HOLCOMB
 1100 HOWELL BRIDGE RD.
 BALL GROUND, GA. 30092
 770-735-1100



P.O. BOX 129
 BALL GROUND, GEORGIA 30107
 770-735-1100

| | |
|--|--------------------------|
| ZONING PLAN -FOR- | |
| HICKORY RIDGE ASSEMBLAGE | |
| LAND LOT(S) - 1169 & 1170 | |
| DISTRICT - 15, SECTION - 2 | |
| CITY: WOODSTOCK | CHEROKEE COUNTY, GEORGIA |
| PREPARED: APRIL 2, 2018 | SCALE: 1" = 50 FT. |
| DWG FILE: SMALL ZONING PLAN.dwg GA. LSF 000080 | |
| JOB NO. 18-4359 | |